

# SOLAR RACING CAR

## INSTRUCTIONS

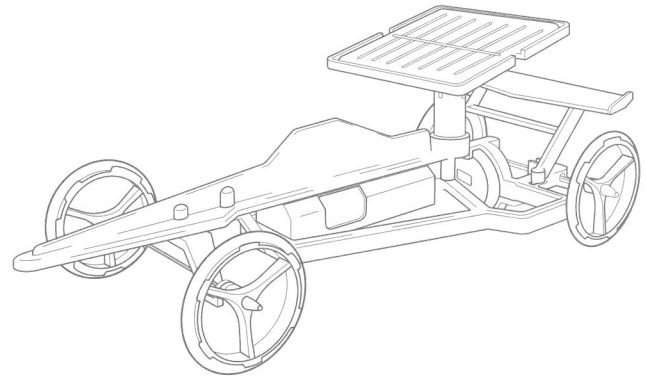

### Specification

Length :	210mm
Width :	80mm
Height :	68mm
Power :	solar / battery

### 5 Assembling the tires

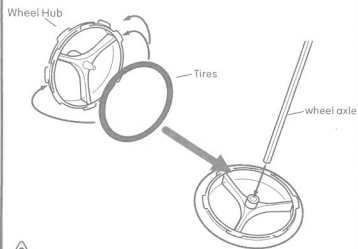

**Notice** Pay attention to the size of hub and tires.

### 6 Affixing the tail

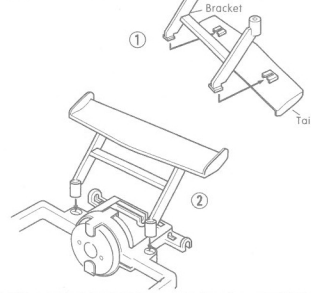

### 7 Assembling the front wheels

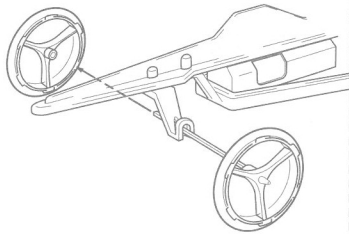

### 8 Attaching rear wheels

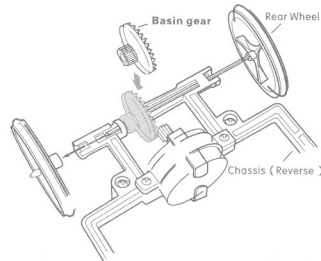

### Operation

- Powered by solar or battery
- When using solar power move the switch to the S position (to get the best performance adjust the panel so it is in direct sunlight)
- When using battery power move the switch to the E position
- Adjust the wheels to ensure a smoother run

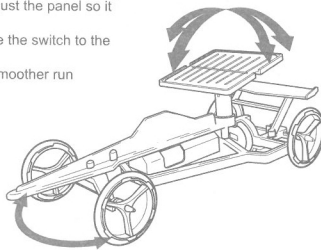

### Caution!

- The kit includes small parts that may be a choking hazard for small children (should not be used by children under 3)
- Do not use on the street or other public areas
- Retain the manual for future use

### Accessory

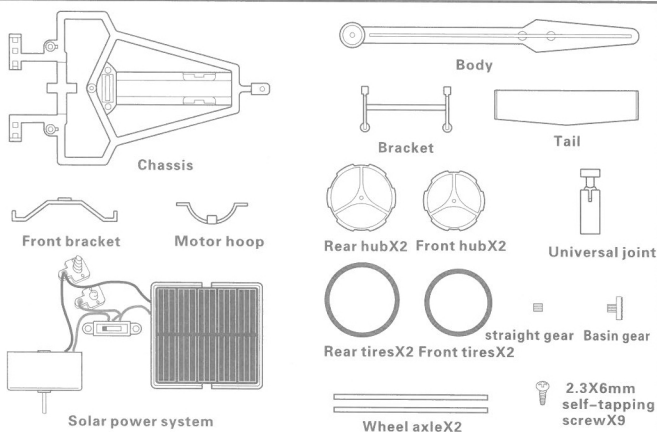

Solar power system

### Tool

**Be careful**



### Assembling

- 1 Attach the straight gear onto the solar motor.

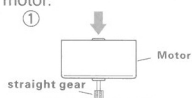

AA Battery(not included)

- 2 Install the motor by screwing to the chassis

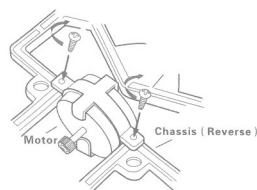

- 3 Attach the switch onto the chassis.

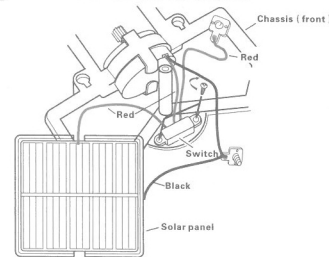

- 4 Attach the battery box.

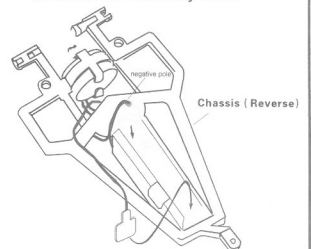

- 2 Assembling the body

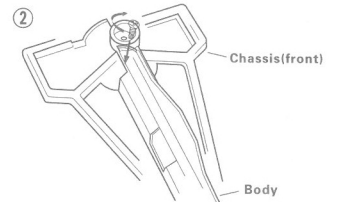
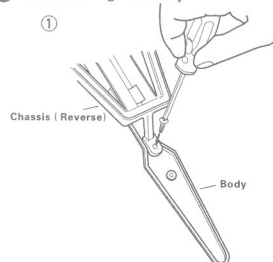

- 3 Assembling the universal joint

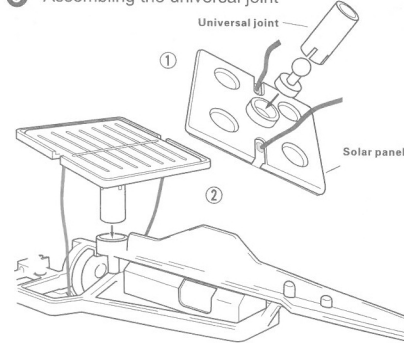

- 4 Assembling the front bracket

